



JLAB AUDIO  
REWIND WIRELESS  
HEADPHONES

We love that you are rocking JLab Audio!  
We take pride in our products and fully stand behind them.



### YOUR WARRANTY

All warranty claims are subject to JLab Audio authorization and at our sole discretion. Retain your proof of purchase to ensure warranty coverage.



### CONTACT US

Reach out to us at [support@jlabaudio.com](mailto:support@jlabaudio.com) or visit [jlabaudio.com/contact](http://jlabaudio.com/contact)

## REGISTER TODAY

[jlabaudio.com/register](http://jlabaudio.com/register)

Product updates | How-to tips  
FAQs & more

## FIRST TIME SETUP: BLUETOOTH PAIRING

- 1 Turn on the Bluetooth in your device settings.

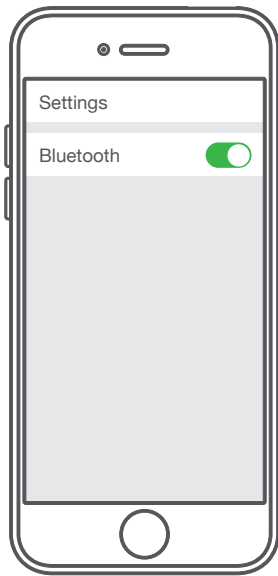

- 2 Press and hold button for **10 seconds**. Release.

Light will **blink red and blue** near the foam ear pad to indicate pairing mode.



- 3 Select "JLab Rewind" in your device settings to connect.  
Light will **slow blink blue** when Bluetooth is paired.

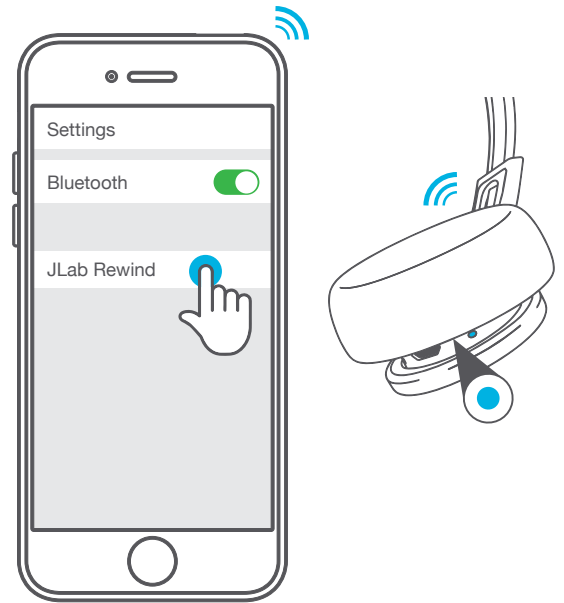

## PAIRING NEW / ADDITIONAL DEVICES:

Turn OFF Bluetooth on your previously paired device and turn ON Bluetooth on new device. Repeat **FIRST TIME SETUP** process for new devices.

### Notes:

- Bluetooth is a wireless radio technology, which means it is sensitive to objects between the headphone and the connected device. The headphone is designed to be used within 33 feet (10 meters) of a connected device, with no major objects in between (walls, etc.).
- Once successfully connected, the headphone will memorize your device and automatically pair when turned on in the future. Only one device may be connected at a time. To pair a different device, first unpair the current one through its Bluetooth settings.
- If for any reason Bluetooth connection is lost, manually reconnect your Bluetooth device.

## CHARGING

**Note: Headphones will not turn on while charging. Allow about 3 hours to fully charge.**

Connect the Rewind Headphone to a computer or USB 5V output device with the provided charging cable.

**Red light** will indicate charging and **blue light** will indicate a full charge.

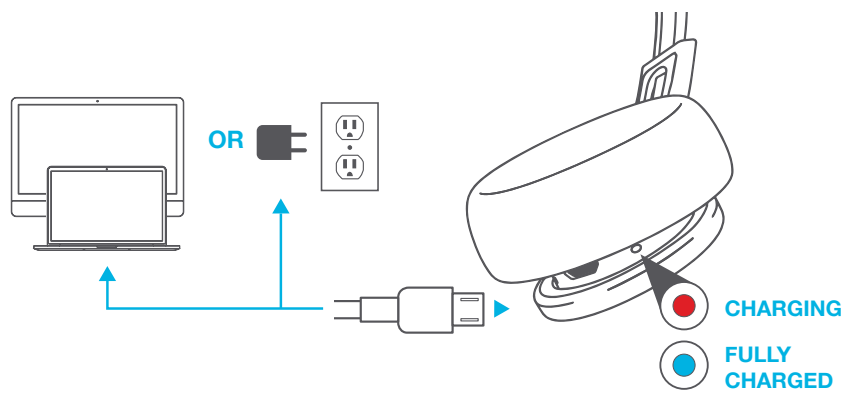

## BUTTON FUNCTIONS

### BLUETOOTH PAIRING:

(Follow First Time Setup instructions)

**POWER ON:** Press & hold 2 seconds

**POWER OFF:** Press & hold 4 seconds  
(slow blinking blue light indicates power is on)

**PLAY / PAUSE / ANSWER / HANG UP:**  
1 click

**ACTIVATE SIRI (iOS) OR  
"OK GOOGLE" (ANDROID):**  
2 click

**TRACK FORWARD:**  
Press & hold 2 seconds

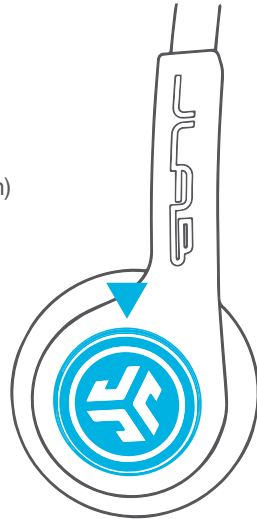

### EQUALIZER MODES

#### TOGGLE EQ CHANGE

3 click. (Rewind will cycle 3 EQ settings)



#### JLab SIGNATURE (One Beep)

JLab C3™ signature  
sound with amplified  
vocals and bass



#### BALANCED (Two Beeps)

Even sound with no  
additional sound  
enhancements



#### BASS BOOST (Three Beeps)

Amplified bass  
and sub-bass

## CAUTIONS

- Avoid getting moisture or liquids on the headphone cups.
- Avoid extreme heat, cold, and humidity.
- Avoid dropping or crushing headphones, stressing the cable by rapid pulling or extreme force, or bending the cable at a sharp angle.
- Wax may build up in headphone cups, lowering the sound quality. Carefully remove the wax with a cotton swab or other small tool to improve the sound quality.
- If you experience discomfort or pain, try lowering the volume or discontinuing use temporarily.
- If you experience regular discomfort while using this product, discontinue use and consult your physician.
- We recommend you treat your headphones as you would a nice pair of sunglasses and keep them in safe location when not in use.



[Shop products](#) | [Product alerts](#) | [Burn-in your headphones](#)

JLab Audio + Burn-in Tool

